

# CERTIFICATE OF LOCATION OF GOVERNMENT CORNER

N1/4 Corner of Section 6, Township 105, Range 42, 5 P.M.

STATE OF MINNESOTA, County of MURRAY

At the corner location shown on the sketch:

On \_\_\_\_\_ found a \_\_\_\_\_  
DATE

left monument as found,  lowered monument,  removed monument (explain)

On Sept. 73 placed a 3/8" x 24" Iron Rod  
DATE

## SKETCH OF REFERENCE TIES

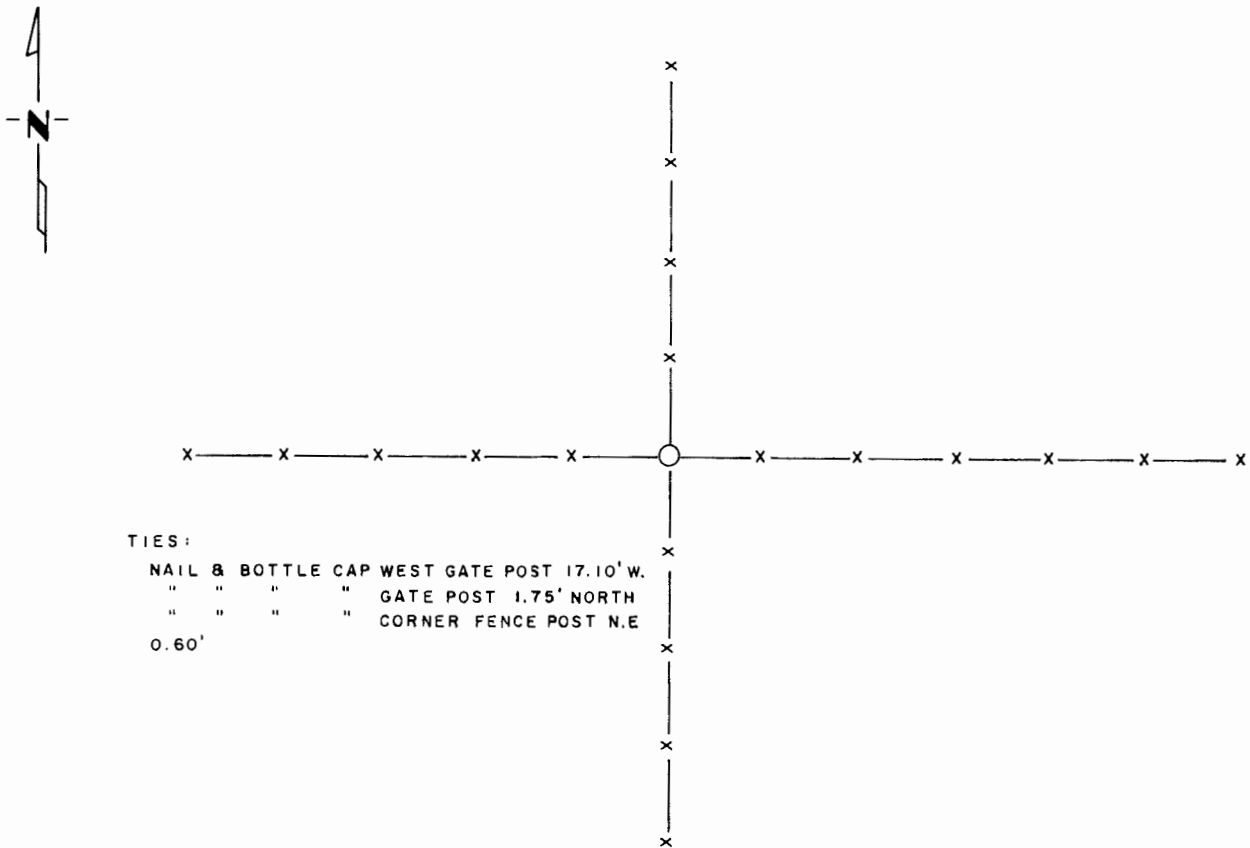

Statement of evidence relative to this corner location is on back of page.

I hereby certify that this document and the data contained herein was prepared by me or under my direct supervision.

Bert R. Evland 7-29-80  
SIGNATURE DATE

Registration No. 10516

Land Surveyor,  Professional Engineer

County Surveyor,  County Engineer

OFFICE OF THE REGISTER OF DEEDS

County of Murray

I hereby certify that this document was filed in the Reg. of Deeds office at 8:30 a.m. on the 9th day of October A.D., 1981

Register of Deeds Willard W. Ohme

By \_\_\_\_\_, Deputy

DOCUMENT NO. 164602

Statement of Evidence:

MINNESOTA DEPARTMENT OF NATURAL RESOURCES, BUREAU OF ENGINEERING.

North Quarter Corner of Section 6, Township 105, Range 42, 5 P.M.  
Murray County.

Corner originally set by Government Land Office in 1866. A post was set - deposited charcoal and made pits and mounds. In July, 1953, a Dept. of Natural Resources Engineering crew assumed the corner but the field notes don't state what was set or the procedure used. However, their sketch shows corner to be at intersection of fences north, east and west.

In August, 1973, said Dept. of Natural Resources Engineering contacted the Register of Deeds and County Engineer but no information was available. Said Bureau of Engineering survey crew assumed the corner and set a 3/8" x 24" iron rod next to a fence corner at the intersection of fences north-south and east-west. Derald Karssen, 50 more or less, owner of the South Half of the Southeast Quarter of Section 31, knew of no marker, but said that the corner fence post is assumed to be in the quarter corner location. The owner of the West Half of the Northeast Quarter of Section 6, Township 105, Range 42, 32 years old more or less, was contacted but he was unable to give helpful information.